

storey house  
with attached garage

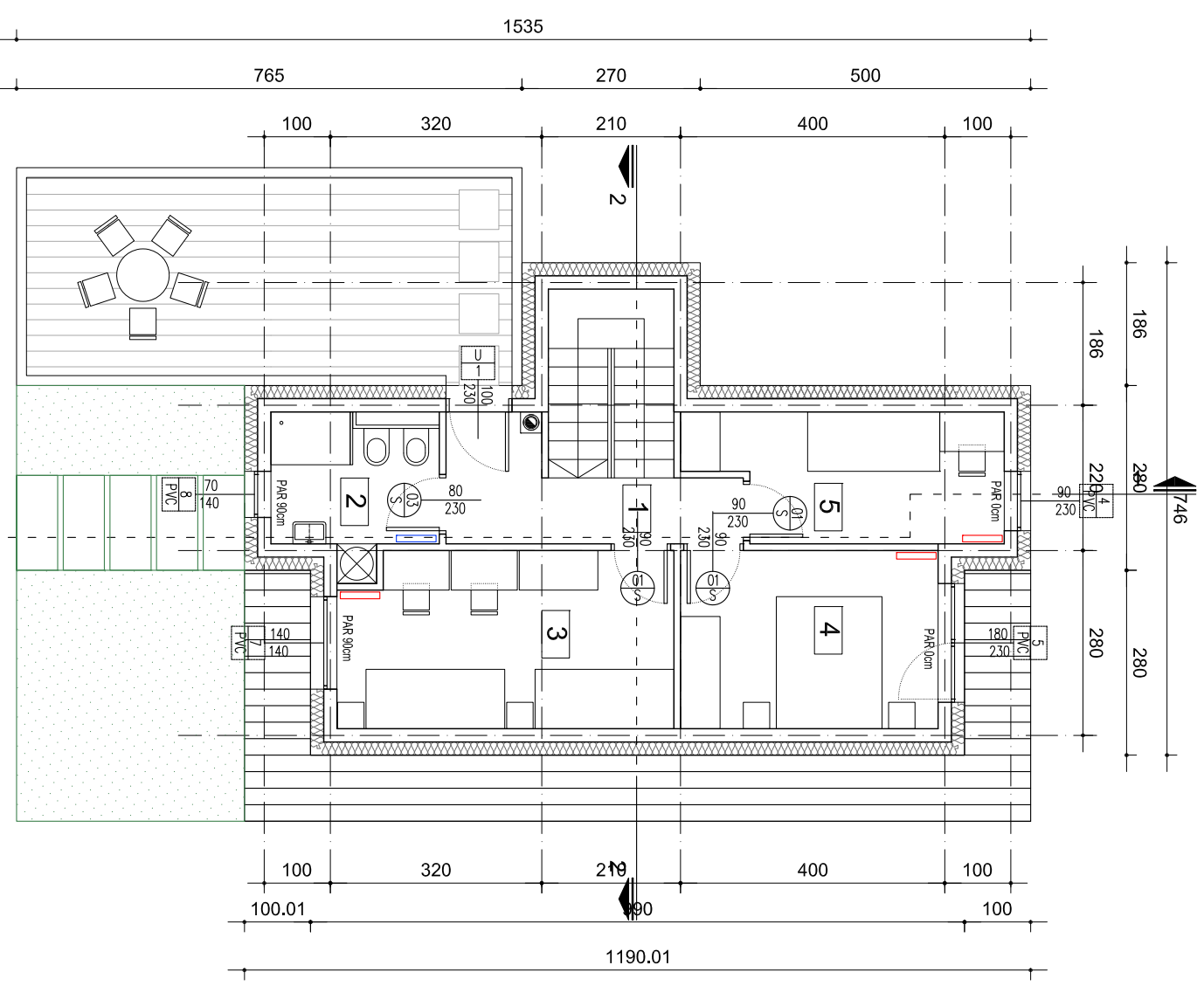
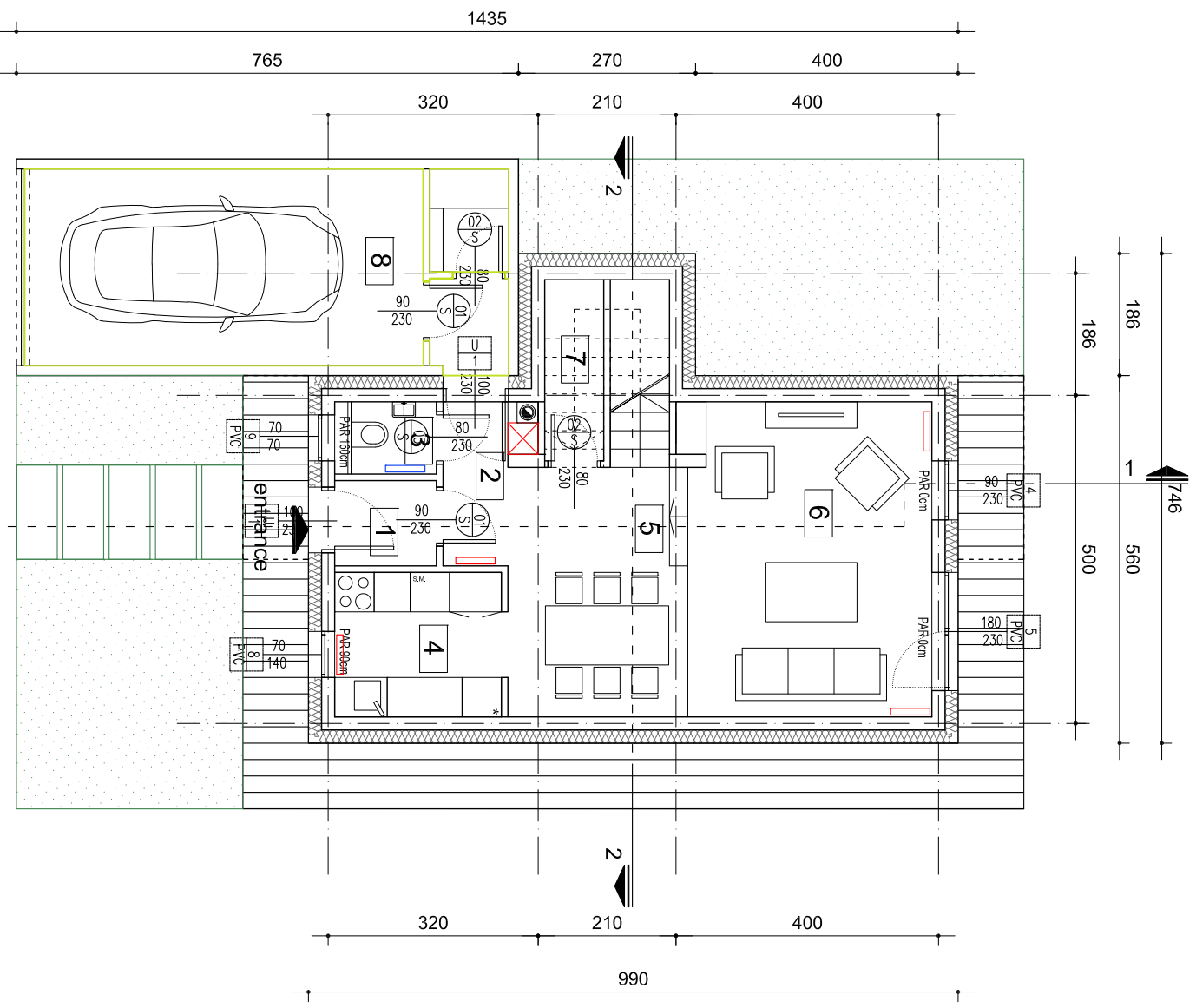

GROUND FLOOR PLAN

1	entrance hall	2.00 m <sup>2</sup>
2	communication	2.75 m <sup>2</sup>
3	toilet	1.45 m <sup>2</sup>
4	kitchen	5.60 m <sup>2</sup>
5	dining room	10.40 m <sup>2</sup>
6	living room	17.95 m <sup>2</sup>
7	storage room	2.50 m <sup>2</sup>
<b>net internal area</b>		<b>42.65 m<sup>2</sup></b>
<b>gross floor area</b>		<b>60.45 m<sup>2</sup></b>
8	garage	22.25 m <sup>2</sup>

FIRST FLOOR PLAN

1	communication	11.30 m <sup>2</sup>
2	bathroom	4.70 m <sup>2</sup>
3	bedroom	13.35 m <sup>2</sup>
4	bedroom	10.50 m <sup>2</sup>
5	bedroom	8.65 m <sup>2</sup>
<b>net internal area</b>		<b>48.50 m<sup>2</sup></b>
<b>gross floor area</b>		<b>66.00 m<sup>2</sup></b>

<b>total net</b>		<b>91.15 m<sup>2</sup></b>
<b>internal area</b>		<b>91.15 m<sup>2</sup></b>
<b>total gross</b>		<b>126.45 m<sup>2</sup></b>
<b>floor area</b>		<b>126.45 m<sup>2</sup></b>

FLOORPLAN	1:100
-----------	-------

