

storey house  
with attached garage

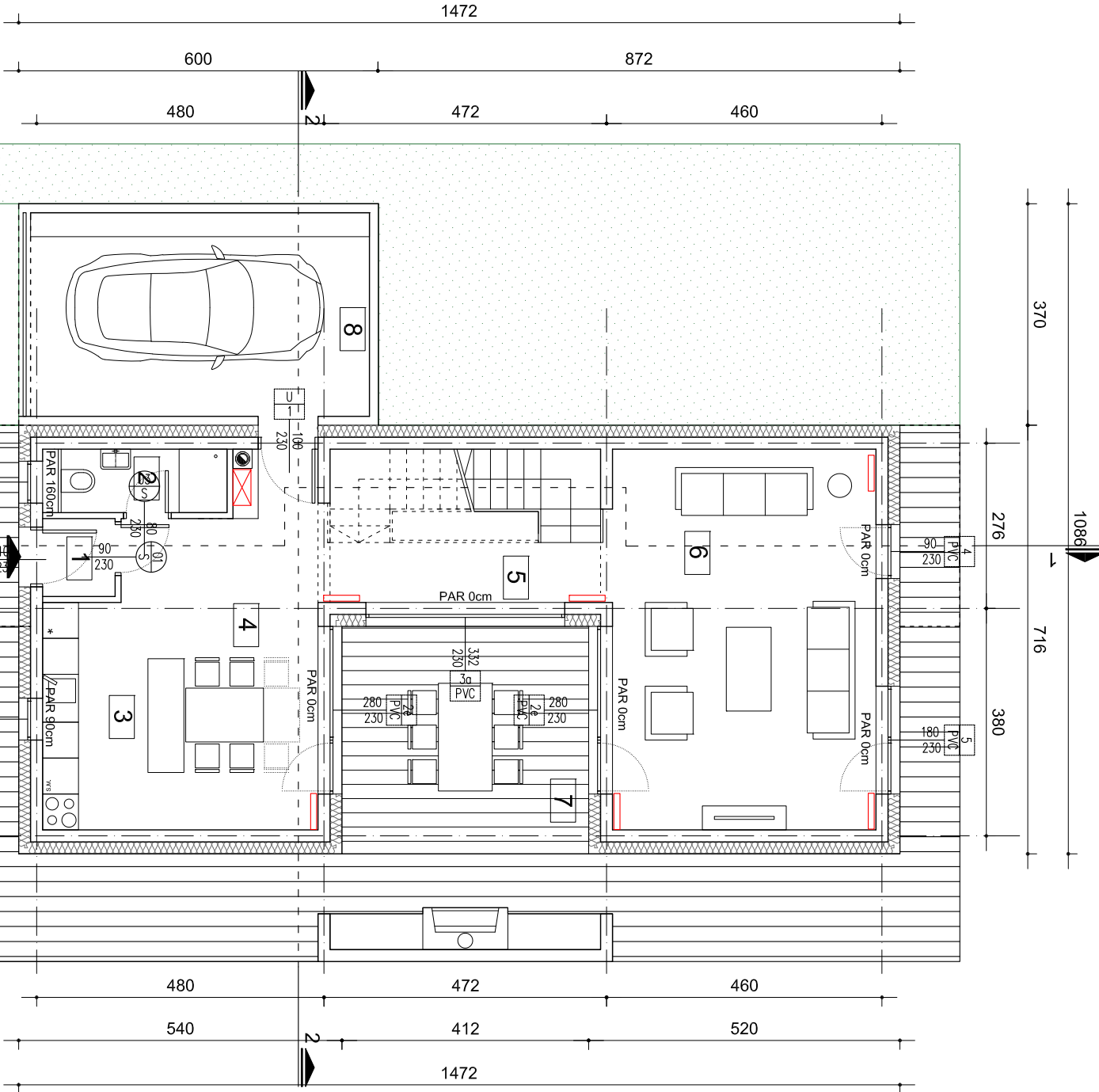

GROUND FLOOR PLAN

GROUND FLOOR PLAN

1	entrance hall	1.60 m <sup>2</sup>
2	toilet	3.25 m <sup>2</sup>
3	kitchen	
4	dining room	17.50 m <sup>2</sup>
5	communication	18.35 m <sup>2</sup>
6	living room	28.00 m <sup>2</sup>
7	atrium	19.75 m <sup>2</sup>
net internal area		88.45 m <sup>2</sup>
gross floor area		89.75 m <sup>2</sup>
8	garage	19.25 m <sup>2</sup>

FLOORPLAN	1:100
-----------	-------