

# OZZA

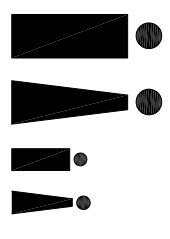

ground floor house  
with separate garage

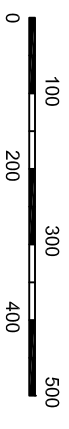
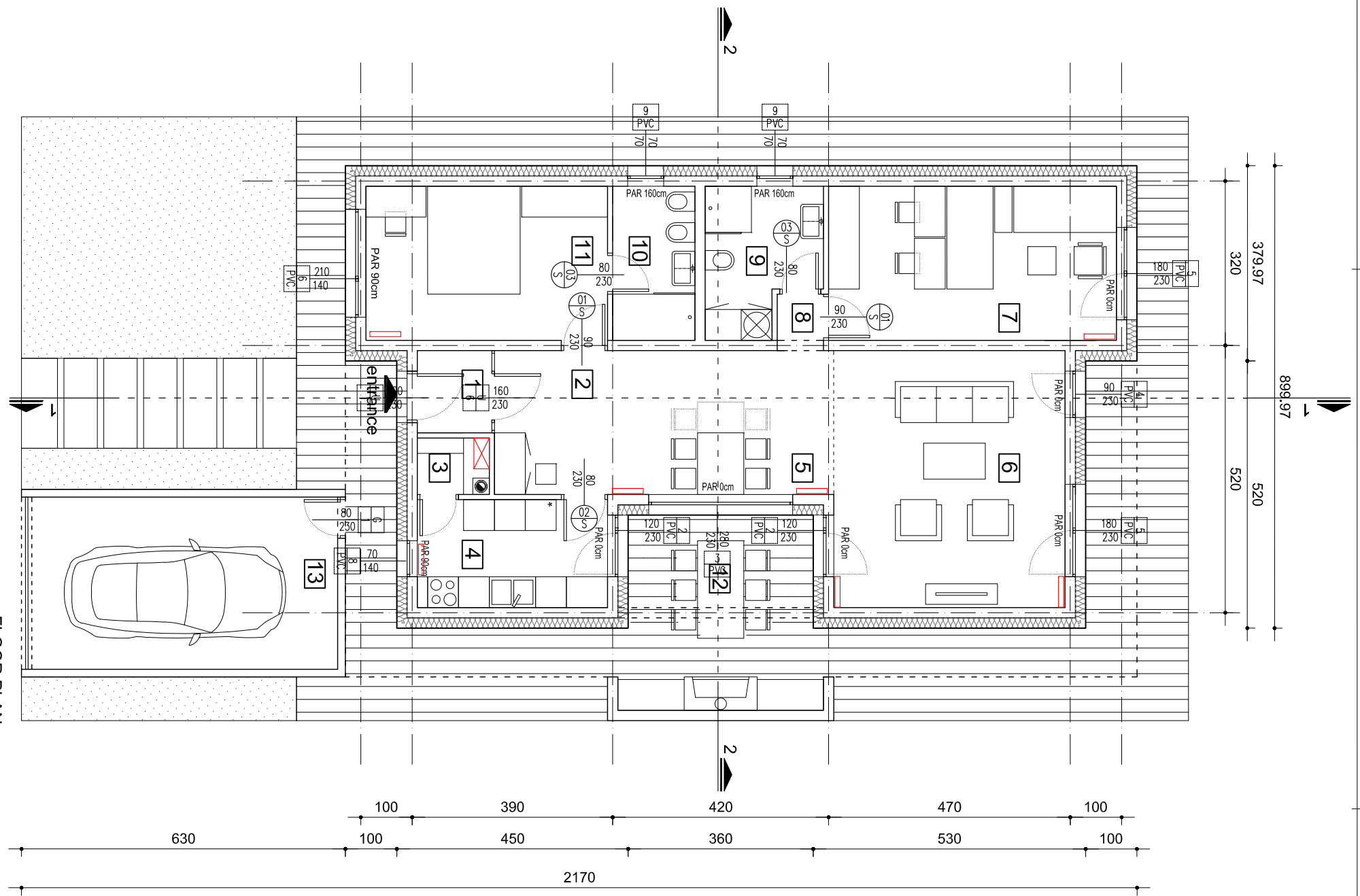

|                          |               |                             |
|--------------------------|---------------|-----------------------------|
| 1                        | entrance hall | 2.30 m <sup>2</sup>         |
| 2                        | entrance area | 6.15 m <sup>2</sup>         |
| 3                        | storage       | 1.50 m <sup>2</sup>         |
| 4                        | kitchen       | 7.75 m <sup>2</sup>         |
| 5                        | dining room   | 12.30 m <sup>2</sup>        |
| 6                        | living room   | 22.50 m <sup>2</sup>        |
| 7                        | kids room     | 16.80 m <sup>2</sup>        |
| 8                        | hallway       | 0.90 m <sup>2</sup>         |
| 9                        | bathroom      | 5.90 m <sup>2</sup>         |
| 10                       | bathroom      | 4.80 m <sup>2</sup>         |
| 11                       | bedroom       | 14.10 m <sup>2</sup>        |
| 12                       | atrium        | 12.10 m <sup>2</sup>        |
| <b>net internal area</b> |               | <b>107.10 m<sup>2</sup></b> |
| <b>gross floor area</b>  |               | <b>120.30 m<sup>2</sup></b> |
| 13                       | garage        | 20.00 m <sup>2</sup>        |

FLOORPLAN 1:100