

izgled, R=1:20

Svetionik

Svetionik se nalazi nedaleko od zapadne obale ostrva Korzika. Kilma na ostrvu je mediteranska (duga, suva leta i kišne i blage zime), pogodna je za boravak tokom cele godine. Svetionik je predviđen za boravak četvoročlane porodice. Do svetionika se dolazi čamcem, koji može da se priveže za dok koji povezuje svetionik i kopno.

The lighthouse

The lighthouse is located near the west coast of the island of Corsica. Kilma the island's Mediterranean climate (long, dry summers and mild and rainy winters), it is suitable for all year round. The lighthouse can accommodate a family of four. To the lighthouse can be reached by boat, which can be tie to the dock that connects the lighthouse and the mainland.

Aleksandra Pantelić
Arhitektonski fakultet, Beograd

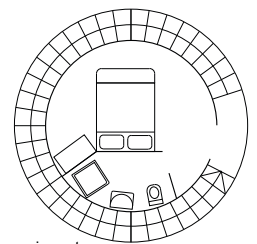

prvi sprat

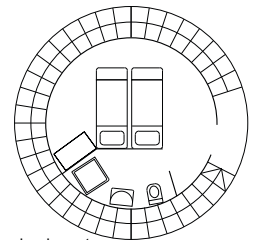

drugi sprat

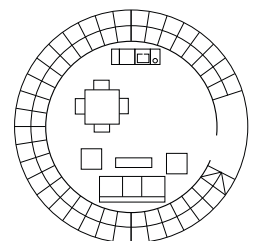

treći sprat, R=1:25